

Features:

AQUECOOL Device:

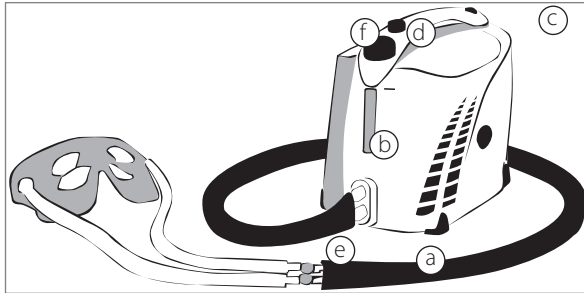

- a) **Device tubing** (grey)
- b) **Water level window:** add water to MAX fill line.
- c) **On/off switch:** press firmly to turn device on or off. Green light will illuminate when unit is on.
- d) **Temperature control knob:** use control knob to adjust water temperature. (CCW = colder)
- e) **Quick disconnects** (white): press silver tabs to quickly disconnect mask. Turn off the AQUECOOL device before disconnecting mask. To reconnect, insert the connectors until they "click".
- f) **Reservoir fill cap:** use distilled or filtered water.

AQUESHIELD Mask:

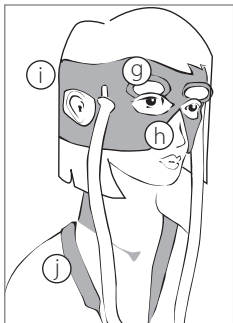

- g) **Eyelid flaps:** close eyelid flaps and tuck edges underneath mask to maximize cooling to eyelids
- h) **Adjustable splint:** adjust splint so that mask forms to nose and around eyes.
- i) **Adjustable headstrap:** use the Velcro head strap to adjust compression to the face.
- j) **Adjustable neckstrap:** use to support weight of tubing

To Set-up the AQUECOOL Unit:

1. Fill the water reservoir to the max level

- Use distilled or filtered water
- Do not overfill



2. Connect the grey device tubing to the AQUECOOL unit

- Insert device tubing quick disconnects (male end) into the AQUECOOL unit until you hear them click.
- If you have difficulty connecting the tubes, firmly press silver tabs on the female end of the connectors until they click. Then re-insert male connectors.

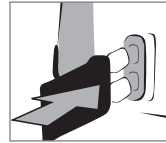

3. Plug the power cord into an electrical outlet.

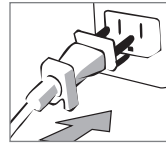

To Use the Mask:

1. Place mask on face. (Neck straps can be worn to support the weight of the tubing)



- adjust for comfort and gentle compression

To Use the Mask (continued)



- Adjust straps at back of head with Velcro closures
- Adjust nose splint so that mask forms to nose and under eyes

2. Connect the mask to the grey device tubing

- Insert white connectors until you hear them click (you should hear 2 clicks, one for each tube)

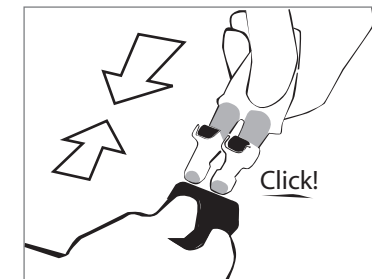

3. Turn on the AQUECOOL unit, and adjust temperature as desired

- Check water level
- Adjust temperature with temperature control knob

4. To disconnect mask, firmly press silver metal tabs on connectors until you hear them click.

Recommended Use:

- Use 8 - 24 hours per day, for at least 2 hours per use. Device may be used continuously.
- Device may be used while sleeping to receive therapy while you rest.
- Use the temperature control knob to choose a temperature that feels cool and soothing. If it is uncomfortable, turn up the temperature (↻ = warmer), or discontinue use for 1 - 2 hours and try again. The water may be controlled between 50°F - 61°F (10°C - 16°C), so expect that it will not feel as cold as an ice pack.
- Begin with the temperature at the highest setting, and as you feel comfortable, reduce the temperature to increase cooling to your face.

Cautions:

- Check skin periodically. If a rash, irritation, or itchiness develops, discontinue use and contact your doctor.
- If the AQUECOOL unit leaks water, discontinue use and contact Aqueduct Medical at 1-877-365-HEAL.
 - *Note: Some condensation may occur on the mask and around the quick disconnects. This is normal and it is OK to continue using the device.*
- Users who are sensitive to cold, or susceptible to injury from cold or compression (external pressure on the skin) should exercise extra caution when using the device.
- Extra care should be taken if the user has any of the following medical conditions: diabetes, incapacitation, impaired circulation and / or compromised skin.
- Extra care should be taken if the user is unconscious, under the influence of prescribed medication, undergoing extended therapy and / or has sensitive skin.

Troubleshooting:

If unit turns on, but does not seem to be cooling:

1. Make sure there is enough water in the system.
2. Ensure that all connectors are properly connected. Firmly press silver metal tabs until they "click" to release. Re-insert the connectors so that they both "click" into place.
3. If unit still is not working, please refer to the more detailed troubleshooting section on page 19 of the AQUECOOL manual.
4. If you are still having problems, please contact Aqueduct Technical Service at 877-365-HEAL



aqueduct medical

AQUEDUCT MEDICAL INC.

665 Third Street, Suite 20
San Francisco, California 94107

phone: (877) 365 HEAL
fax: (415) 543 2640
www.aqueductmedical.com

Periorbital Mask 32-0006-002 Rev B

AQUESHIELD PERIORBITAL Mask

Patient Instructions



aqueduct medical